

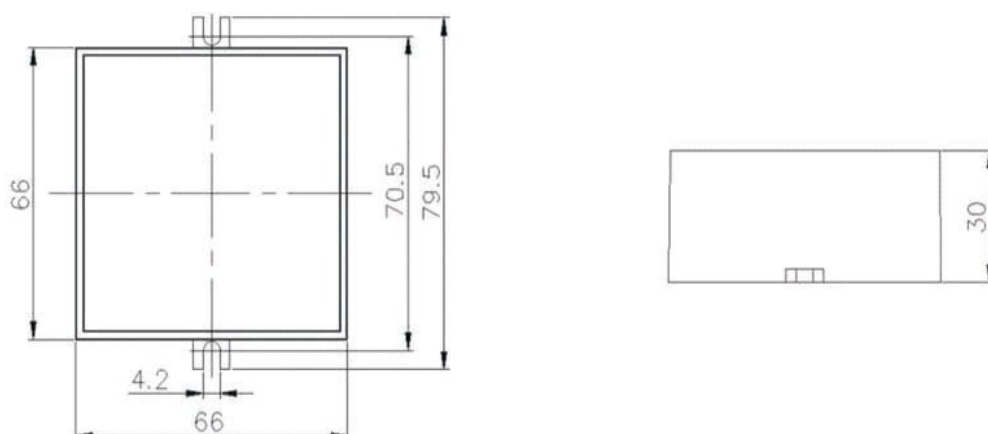

HID BALLAST 20W

Model: HM0020



Product highlights:

- *Steady lamp performance by mains fluctuation and lamp tolerance.
- *Constant lamp power output and stable lamp colour temperature.
- *Abnormal protection against empty load, overheat, lamp end of life, lamp operation voltage too high or too low. Restart on removing of obstacles and power reset.
- *Suitable for CDM, CMH, and HCL.
- *Pulse interval ignition.
- *Over 90% lumen factor during the lamp life.
- *Comprehensive energy saving by 35%.
- *High power factor; EEL = A1.
- *50,000 service hours at Tc max.

