

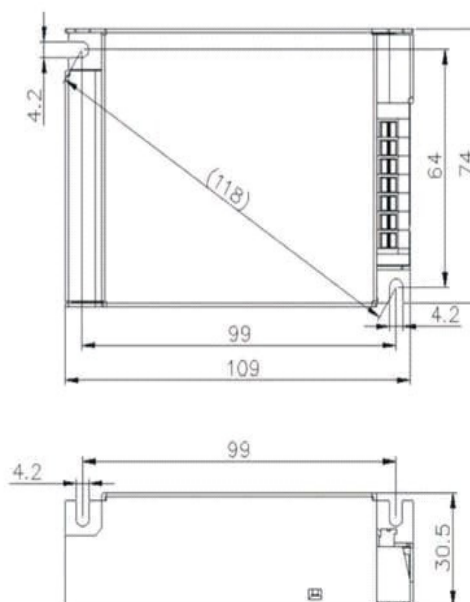

HID BALLAST 35W

Model: HM1035



HID BALLAST 70W

Model: HM1070

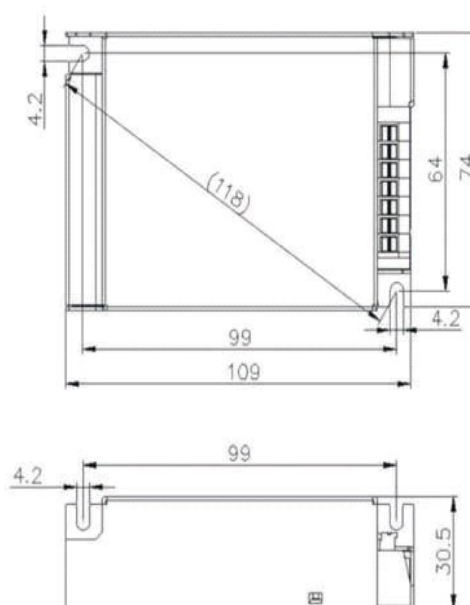
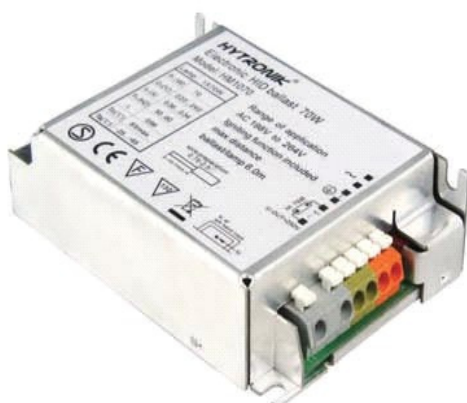

Product highlights:

- *Steady lamp performance by mains fluctuation and lamp tolerance.
- *Constant lamp power output and stable lamp colour temperature.
- *Abnormal protection against empty load, overheat, lamp end of life. Restart on removing of obstacles and power reset.
- *Suitable for CDM, CMH, and HCL.
- *Pulse interval ignition.
- *Over 90% lumen factor during the lamp life.
- *Comprehensive energy saving by 35%.
- *High power factor; EEI = A1.
- *50,000 service hours at Tc max.

Model: HM1035 Technical parameters:

Input voltage:	220—240VAC
Mains current:	0.21-0.19A
Supply frequency:	50/60Hz
Power factor:	0.98
Operation frequency:	120Hz
Ta:	- 25~ + 50℃
Tc:	Max 75℃
Ignition voltage:	Max. 4 Kv.
Lamp power:	37W (max)
Degree of protection:	IP20
U-OUT	300V

Model: HM1070 Technical parameters:

Input voltage:	220—240VAC
Mains current:	0.37-0.34A
Supply frequency:	50/60Hz
Power factor:	0.98
Operation frequency:	120Hz
Ta:	- 25~ + 45℃
Tc:	Max 80℃
Ignition voltage:	Max. 4 Kv.
Lamp power:	73W (max)
Degree of protection:	IP20
U-OUT	300V

Approvals and standards:

This ballast is tested and approved according to EN61347-2-12, EN61347-1, EN55015, EN61547, EN61000-3-2, EN61000-3-3.